

## NOTICE OF INTENT TO ANNEX

The City Council of the City of Harrah proposes to annex into the city limits of the City of Harrah, Oklahoma, Tracts 1 through 6 indicated on the attached Exhibit A, Proposed Annexation Exhibit prepared by Myers Engineering, and further described on the enclosed legal description attached hereto as Exhibit B.

This Notice is required to be sent to all owners within the Proposed Annexation Area ("PAA") and all owners of tracts adjacent to the PAA. If your tract is not within the PAA, this proposed action does not directly affect your property.

A public hearing will be conducted by the Harrah City Council at Harrah City Hall located at 19625 NE 23<sup>rd</sup> St., Harrah, OK on the 27th day of September, 2011 at 7:00 p.m. to take comments, suggestions and opinions concerning this proposed annexation and to discuss potential beneficial changes to the annexation plan and the service plan, which will be available for inspection at City Hall at the time of the public hearing.

Services to be provided to the PAA include but are not limited to the following:

- a. Immediate police and fire service and protection;
- b. Immediately available waste disposal service, if needed, at municipal rates;
- c. Immediate availability of domestic animal control;
- d. Sewer and water service will be immediately available to property in close proximity, within 300 ft., to Harrah Rd.;
- e. Water service shall be available along section line roads, as indicated on attached Exhibit A, showing "future water main" lines, within 120 months of the date of annexation, and will then be available for connection and for future development;
- f. Other water and sewer shall be by private well and septic as is presently utilized in the majority of the existing Harrah municipal limits;
- g. The service plan will be completed within 120 months from the date of annexation unless altered as discussed herein.

The plan for extension of services will be available for inspection and discussion at the City Hall meeting, referenced above. The scope and timetable of the service plan can be changed if a different plan is agreed upon by a consensus among the property owners. Your opinion is valued.

EXHIBIT A

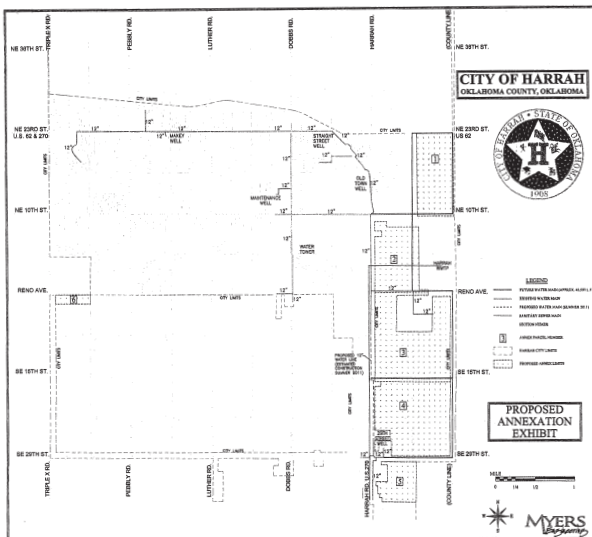

Tract 1:

East half of Section 25, Township 12 North, Range 1 East.

Tract 2:

West half of Section 36, Township 12 North, Range 1 East.

Tract 3:

Section 1, Township 11 North, Range 1 East (less presently existing industrial park already located in Harrah municipal limits).

Tract 4:

Section 12, Township 11 North, Range 1 East (less the tract located in the southwest portion thereof, which is already located in Harrah municipal limits).

Tract 5:

The Northwest Quarter of Section 13, Township 11 North, Range 1 East (less that portion of said quarter section which is already located within the Harrah municipal limits).

Tract 6:

The North 370' of the Northwest Quarter, Section 5, Township 11 North, Range 1 East.